



1. LINK BUILDING

Access will be within the College grounds via a new glazed link building with a zinc clad frontage. The main entrance to the link building will be next to Grey Schools, and there will also be access via the rear of Grey Schools. Descending a flight of stairs will lead into an opening that will be created in the southern façade. Assisted access will be via a small lift in this part of the building.



2. SOUTH TRANSEPT – ENTRANCE AND RECEPTION

When you set foot in St Andrew's, you arrive at the South Transept, - below which the Stevens family vault is believed to be housed. Ahead of you, you will see the welcome desk, which will be staffed by an Information Professional, always ready to help pupils with their research queries.



3. SOUTH AISLE – READING ROOM

On the left of the welcome desk a ramp and steps lead down to the South Aisle reading room surrounded by the fiction collection, where pupils can read for pleasure. A potential space for the Lower School and Tutor group meetings.

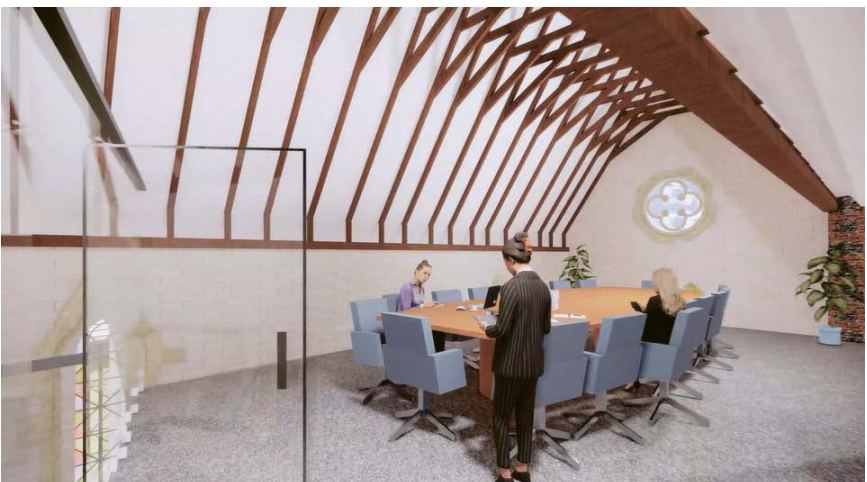

4. SOUTH AISLE – MEZZANINE

In front of the reading room an elegant spiral staircase with glass balustrade leads to a new mezzanine that will be equipped in the same way as a classroom, with a presentation screen and writable glass. This mezzanine provides an ideal group work area or seminar space.

PUBLIC ACCESS

Following conversion, the St Andrew's building will form part of Bradfield College's private grounds, however the churchyard still belongs to Bradfield Parochial Church Council (PCC) and as such will remain open to the public. The College recognises the significance of the building to the local community, as a place which they may wish to occasionally visit and therefore will arrange pre-organised visits opportunities from time to time outside normal College operations. Additionally, the College already provides access to its facilities for specific community groups, on occasion, and the new study centre and library will increase the facilities we share with these groups.

EXISTING FIXTURES & FITTINGS

The Diocese and Church Commissioners, in consultation with Historic England, have determined which fixtures and fittings are to remain in the building and as part of this process, it was decided that the font will remain in-situ with one or two decorative pews placed around it. Memorial plaques will either remain in the Church or be handed over to relatives - depending on the relatives' preference - and the ornate rear choir stalls will be incorporated into the proposed design, whilst the front choir stalls are to be removed and replaced with bespoke tables to create study spaces. The features that are not to be retained are to be auctioned off and the proceeds donated to the local parish.

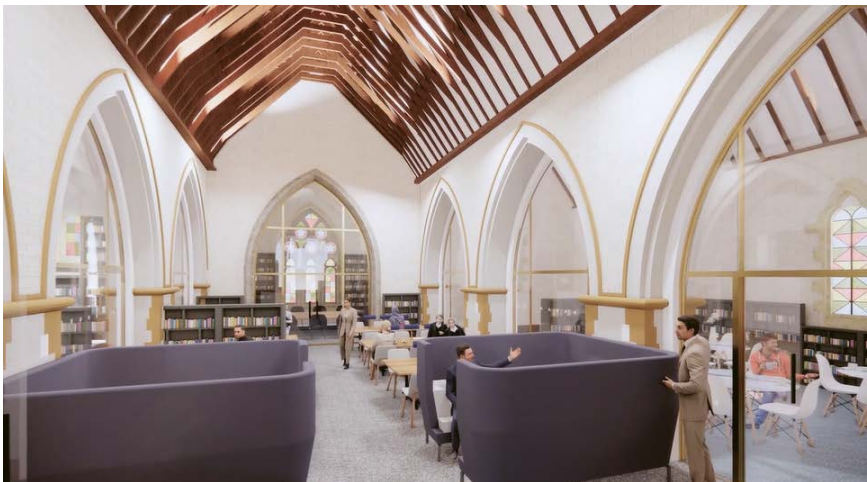

5. NAVE – CENTRAL AREA

This central area, the former nave, will be furnished with seating booths that will also provide acoustic benefits as well as open tables to enable group learning. Overall, the proposals seek to accommodate over 13,000 books designed to fit around the architectural features and fixed memorials in the grade 2* listed building.



6. THE TOWER – MEETING ROOM

A cosy room that will be a bookable space for potential use by tutor groups and as well as pupil project teams.



7. THE FONT – ARCHIVE AREA

This piece of Bradfield history will remain in situ, along with two memorial benches. Shelves in the area will show case works by Old Bradfieldians and this is the space where archive materials will be displayed.



8. NORTH AISLE – INFORMAL AREA

The ground floor of the north aisle will accommodate a self-service refreshment area and seating for informal study, discussion and a TV screen displaying news events. This is the area where pupils will be able to access the magazines, newspapers, and journals that the College has on subscription.



9. NORTH AISLE – TIERED SEATING AREA

Accessed through a glass door, we enter the North Aisle, a cosy space with tiered timber seating and a smart board for pupils to practice presentations, relax and study. The stair way at the end leads to the other new mezzanine.



10. NORTH AISLE – MEZZANINE

The North Aisle mezzanine provides another flexible collaborative study space and a cantilevered balcony overlooks the refreshment area below.

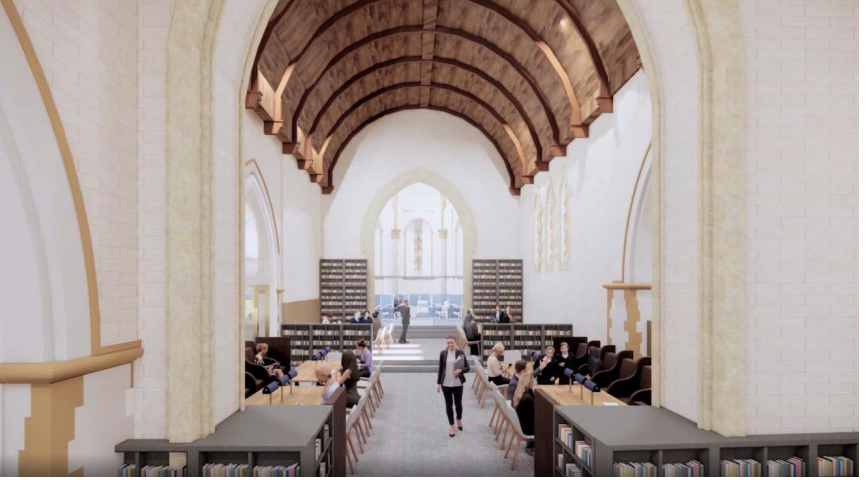

11. THE CHANCEL – INDIVIDUAL STUDY Lower Chancel

The Lower Chancel will be an area for quieter study, the fixed misericords, or choir stalls, will be retained with bespoke tables and additional seating.



Upper Chancel

There will be further large tables in the Upper Chancel.

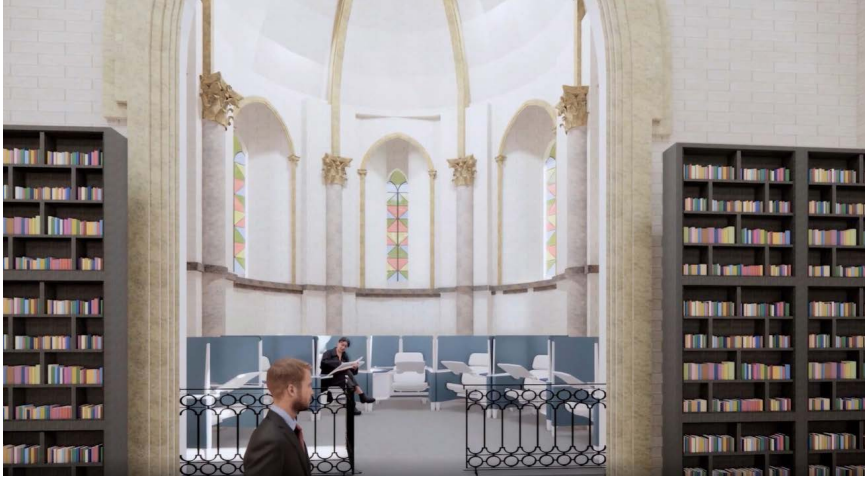

12. THE SANCTUARY - SILENT STUDY

This secluded area will be fitted with a set of silent study booths, perfect for examination and individual preparatory work.

ACCESSIBILITY

Limited mobility access into the Church will be achieved through the provision of a platform lift in the link corridor and again in the south transept and a ramp thereafter to gain access to the South aisle. To prevent unnecessary changes in level and maximise access within the building a timber raised floor will be introduced throughout the nave, south and north aisles. The original floor will be retained beneath, and the new floor will be a reversible feature.

ACOUSTICS

The building has been subdivided into assorted styles of work zones and these zones are separated by glass to maintain the light and feeling of openness, but at the same time prevent noise travelling between the different zones. The zones will range from 'noisy' areas, eg in the café, through collaborative study space, to areas for silent, individual study.

New glazed screens with powder coated steel frames that tie in with the sandstone quoin details will be inserted between the arches and columns to sensitively divide the large building into smaller spaces whilst retaining the visual openness of the original church.

